

Channel Drains (Extract from Reclad guide)

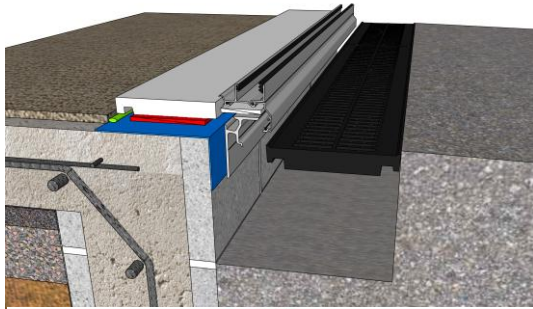

Acceptable Solution E2/AS1 permits the use of channel drains across door openings for **provision of level access only**. Where building consent applications utilise this acceptable solution design plans **must** include **design detailing** showing clearance of wall cladding and wall framing, adjacent the door opening, in relation to finished ground and channel drain ends.

Utilising the depth of a channel drain to achieve 'cladding and wall framing clearance' **is not** acceptable for the following reasons:

- Channel drains are often poorly maintained, leading to durability failure of close proximity cladding and framing
- Close proximity of cladding prevents maintenance of the cladding bottom edge allowing wicking of moisture up into the cladding, and can lead to decay of the wall framing bottom plate
- No less than minimum paved ground clearance must be provided to ensure rain splash-back or moisture from the ground does not accumulate at the drip edge of the cladding or be induced into the cavity.
- There is a risk that dampness in channels may raise the moisture level in the adjacent wall cavity.

